

Party Pumps

Party pumps are generally used in single keg special event environments. For example: Picnics, backyard BBQ's, beach parties, etc. The hand operated pump is the pressure source that forces the beer out of the keg. A classic mistake when operating a party pump is that the user will pump first and then open the faucet, this generally results in a faster (foamy) pour.

Proper Dispensing/Pumping

1. Tap the keg.
2. Open faucet until all pressure is relieved.
3. Open faucet and begin pumping until desired flow is reached.
4. Stop pumping, only pump with faucet open.
5. Repeat step #3 until keg is emptied.

Keeping it Fresh

After purchasing the keg, it is recommended to cover the keg with a blanket or keg jacket. This will insulate the keg and keep it cool during transit.

Transport the keg directly to the location in which it will be dispensed and put keg in a barrel of ice. Keep pump and keg out of direct sunlight. When not in use, submerge faucet and beer line in ice on top of keg.

Note: To prevent party pump and keg valve damage, do not use the party pump to lift keg.

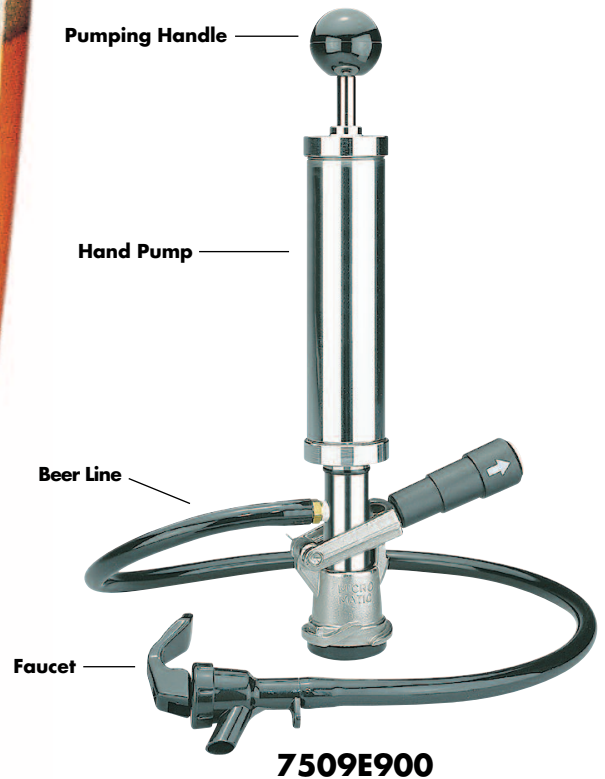

Easy Party Pump Cleaning Procedure

1. Remove cleaning bottle cap. Mix cleaning chemical with water per manufacturer's instructions.
2. Screw cap back on to bottle and engage party pump as if tapping a keg.
3. Pressurize cleaning bottle with party pump and release cleaning solution by squeezing faucet, allowing approximately 1 liter to flow out.
4. Pull pressure relief valve to release bottle pressure before removing bottle cap. Remove cleaning bottle cap. Pour fresh water into cleaning bottle. Screw bottle cap back on and engage party pump.
5. Pressurize cleaning bottle with party pump and release fresh water by squeezing faucet, allowing approximately 1 liter to flow out.



M5-801147



MM-B68



FT101L
O-Ring Lubricant

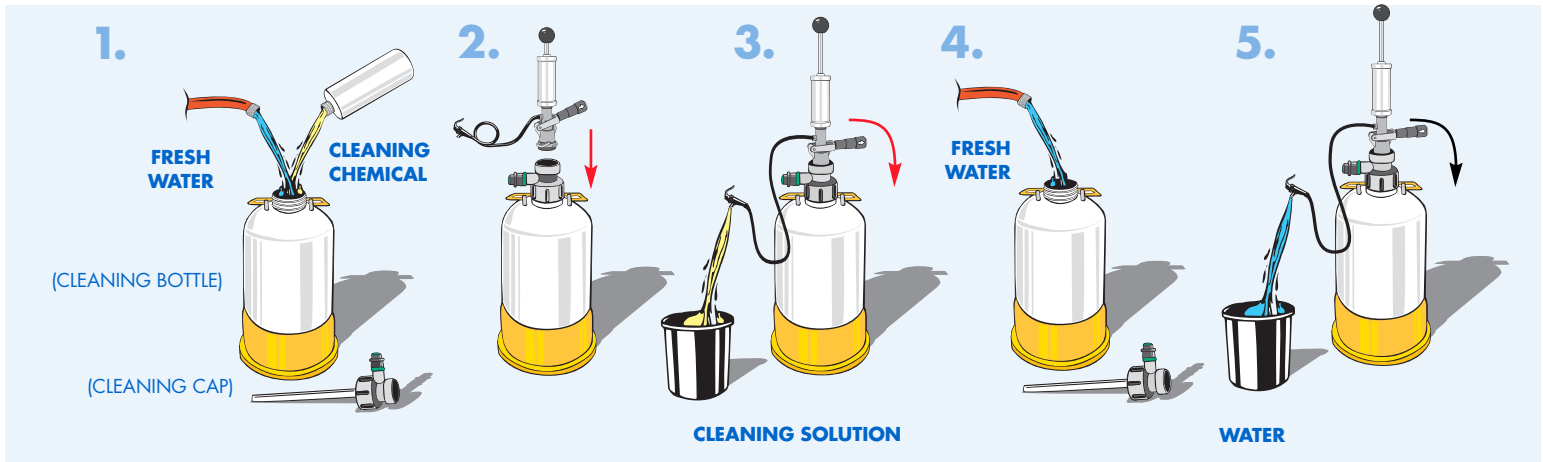

Party Pump Styles

There are a variety of hand pumps used in the industry today. Pumps are usually plastic or metal and are available with a short barrel or long.



3" Plastic Pump
With Plastic Piston



8" Plastic Pump
With Plastic Piston



8" Plastic Pump
With Stainless Steel Piston



4" & 8" Chrome Plated Pump
With Stainless Steel Piston

Hand Pump Servicing

Hand pumps occasionally need to be disassembled and serviced. You must check the O-ring to make sure that it is properly lubricated and sealing to the barrel. Always use FT101L O-ring lubricant (food grade).

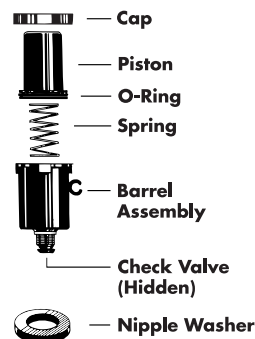

HP-300

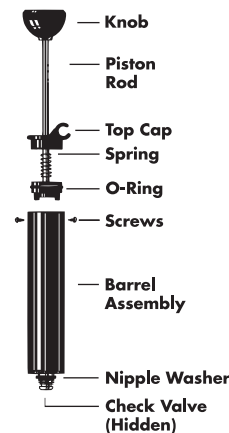

HP-100

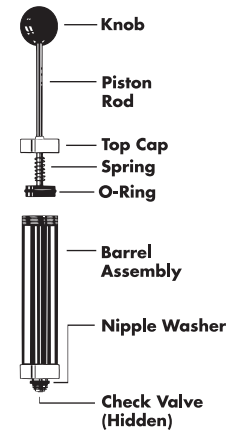

HP-700 & HP-900